

9000 Series



MK11 Printhead



Reliable by design

Linx 9000 Series

MK11 Printhead

The Linx CIJ printhead is designed to take care of itself by reducing hands-on intervention, risk of damage and unexpected interruptions it helps to eliminate some of the most common causes of unplanned downtime and focus on maintaining production flow.

Built-in automatic cleaning

AutoFlush cycle

Automatically prevent blockages at every startup and shutdown; the unique Linx AutoFlush cleaning routine automatically cleans the printhead nozzle and gutter line from the inside, to prevent ink buildup and eliminate unplanned downtime. It uses no additional solvent, great for you and the environment.

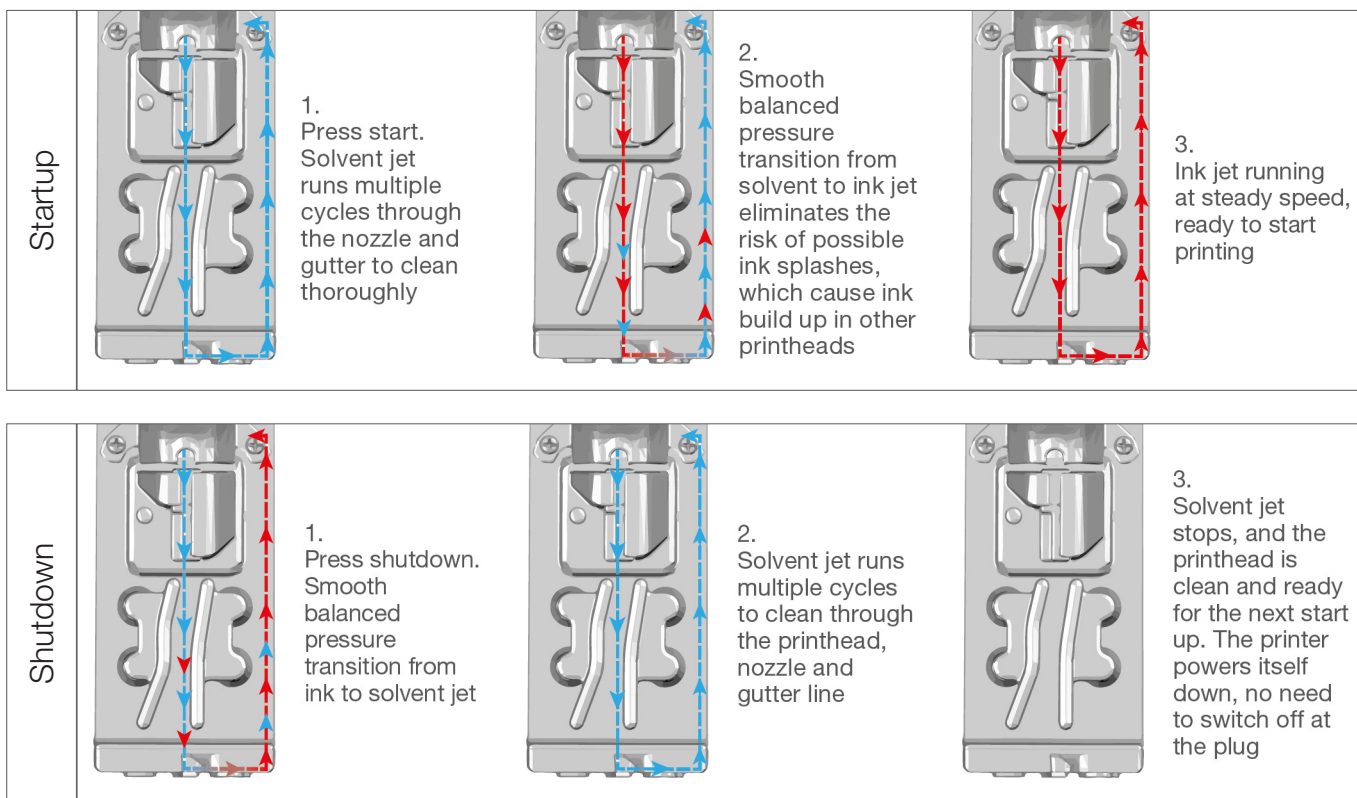

Watch how AutoFlush works

No printhead damage

The most robust printhead

Sealed critical components protect against liquids and harsh environments, with a robust cover tube for added impact protection. The internal parts require no adjustment or replacement, no complicated nozzle changes, and curved plates reduce charge concentration and ink build-up.



Clear and legible print

Automatic sensing

The printhead automatically senses changing environmental conditions, allowing the system to make instant adjustments for consistent print quality.

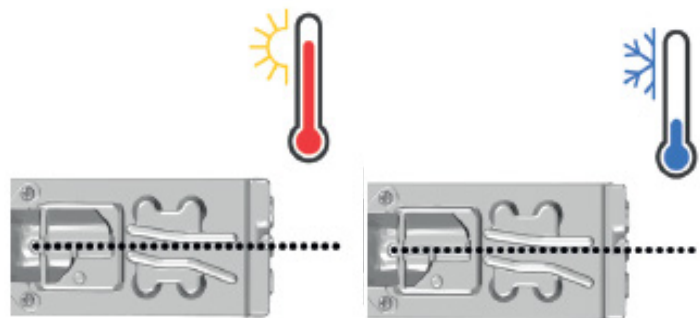

No manual cleaning

Clean, thorough, safe

Protect your printhead and operators with the Linx SureClean® automatic wash station, preventing downtime caused by ink build-up. 11 jets clean the critical components, and a built-in fan dries the head for immediate restarts. Operators can achieve a thorough, safe clean in 5 minutes—with no training or contact with cleaning fluids.



Suitable for any application

Mounting and conduit options

Mount the Linx printhead easily in any direction, without losing print quality, with the range of Linx printhead mounting accessories. Easily mount the Linx Iris vision camera and sensors directly to the printhead cover tube. Choose from three conduit lengths, hydrogen peroxide resistant option or a right angled printhead, ideal for confined spaces.



Linx 9000 Series

MK11 Printhead

Technical Specifications

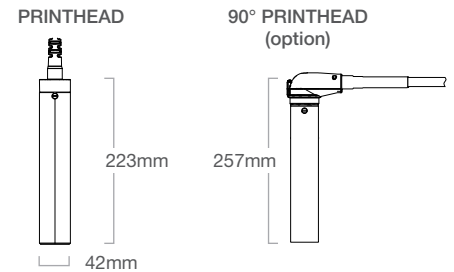

| | | |
|--|--|---------------------------------|
| PRINTHEAD | Unique AutoFlush automatic printhead flushing and conduit clearing | |
| | 2m conduit. 4m conduit (option), 6m conduit (option (not available on MK11 Mini printhead)). 60mm minimum bend radius in static applications. 180mm minimum bend radius in dynamic applications. | |
| | 90° printhead with 270° degree adjustable positioning (option), Hydrogen Peroxide resistant conduit (option) | |
| | Positive air purge for dusty or humid environments (option) | |
| | Air dryer (provides improved reliability for certain inks at high humidity and temperature) (option) | |
| LINX SURECLEAN® WASH STATION | Compatible with all straight printheads (option) | |
| LINES OF PRINT | Up to 6 | |
| MK11 MINI PRINTHEAD (50 µm) | | |
| CHARACTER HEIGHT RANGE | 1.2mm to 11.2mm | |
| MAXIMUM SPEED | ONE LINE PRINT (5 DOT HIGH) | 6.28 m/s (0.43mm drop pitch) |
| | TWO LINE PRINT (7 DOT HIGH) | 2.44 m/s (0.43mm drop pitch) |
| MK11 MIDI PRINTHEAD (62 µm) | | |
| CHARACTER HEIGHT RANGE | 1.8 to 20mm | |
| MAXIMUM SPEED | ONE LINE PRINT (5 DOT HIGH) | 7.50 m/s (0.47mm drop pitch) |
| | TWO LINE PRINT (7 DOT HIGH) | 2.65 m/s (0.43mm drop pitch) |
| MK11 MIDI PLUS PRINTHEAD (75 µm) | | |
| CHARACTER HEIGHT RANGE | 2.1 to 20mm | |
| MAXIMUM SPEED | ONE LINE PRINT (5 DOT HIGH) | 9.10 m/s (0.57mm drop pitch) |
| | TWO LINE PRINT (7 DOT HIGH) | 2.56 m/s (0.52mm drop pitch) |
| | SUPER-FAST TOWER PRINT (5 DOT HIGH) | 10 m/s (0.63mm drop pitch) |
| PRINT CAPABILITIES | Text, Symbols, Numbers, Dates, date rounding (using the printer's internal clock), Times, Graphics, Logos | |
| | Rotated character (tower) printing, Inverted printing, Bold character printing (up to 9 times) | |
| | Variable character spacing and inverse image printing, for improved readability and vision system recognition | |
| | Sequential numbering (forward and backward counting, variable intervals, multiple number ranges, alphanumeric sequencing) | |
| | Barcodes (ITF 2 of 5, Code 39, Code 128, EAN 13, EAN 8, UPCA, Pharmacode, Data Matrix, GS1 Data Matrix, QR, RM4SCC-Type C) | |
| | Dynamic orientation for printing on traverse applications | |
| | Accurate marking at regular intervals i.e. 'metre marking', with rollback to detect lines running backwards and high precision calculation options | |
| Sequential text fields, increment and reset sequences using external triggers, optional one-touch sequence reset from the printer screen | | |
| INK AND SOLVENT | Dye based black and colours, soft pigmented colours, hard pigmented white and colours | |

Refer to product Technical Specifications for the print capabilities and options for each 9000 Series printer model

Global Sales

+44 (0)1480 302100
sales@linxglobal.com

UK Sales

+44 (0)1480 775 223
uksales@linx.co.uk

France Sales

+33 1 72 07 17 05
info@linx.fr

China Sales

021-80504700
chinasales@linxglobal.com

